

Quick Setup Guide

Indoor FHD Security Camera

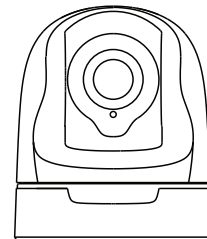

To view this guide in other languages (e.g. Español, Français, Deutsch, Nederlands), and for detailed manuals, tools, etc., please visit foscam.com/downloads.

V1.4

Setting Up Your Foscam Security Camera

A. Getting Started

Package Contents

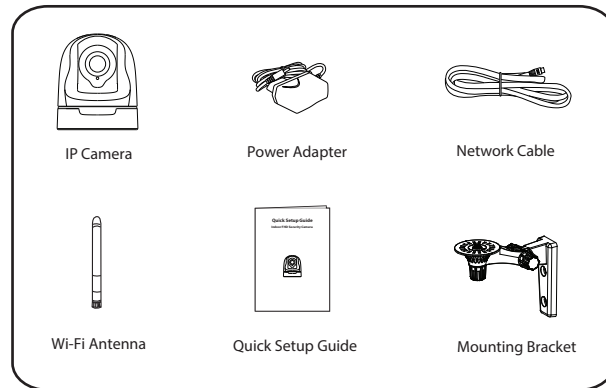

Security Tips

- Please change the password of your camera regularly, using a combination of numbers, letters and special characters.
- We recommend that you regularly update your camera to the latest available software and firmware versions to help ensure the best experience for your camera.

B. Physical Description

Front View

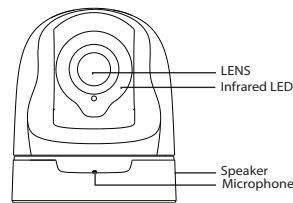

Rear View

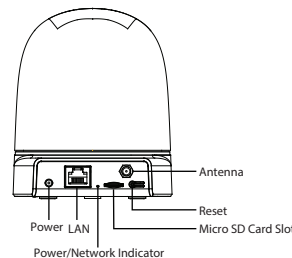

Bottom View

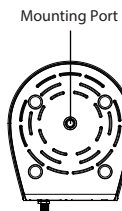

Power/Network Indicator: It lights red when the power is ON but the network is disable; It lights gree when the power is ON and the network is enable.

Warning:



The cords on this product presents a potential strangulation hazard. For child safety, please keep these cords out of the reach of children.

C. Setting Up Your Camera: Wired Connection via Foscam App (Recommended)

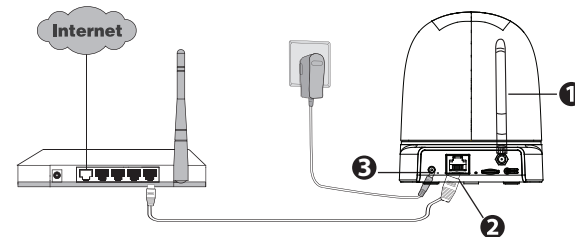

Note: We highly recommend that you first begin the setup process by connecting your camera to your Internet router with an Ethernet cable. After setup is successful and setting up the WiFi network, you'll be able to unplug the cable and login to your wireless network for WiFi operability.

Minimum Requirements:

To help ensure a smoother video experience on the smartphone, it's recommended that your smartphone has the following:

- iOS: version 8.1 or higher.
- Android: 4.1 or higher, using a device with a Graphics Processing Unit (GPU) function.

Camera Setup Steps

1. Please mount the antenna and make sure it is in a vertical upright position.
2. Connect the camera to your Internet router using an Ethernet cable.
3. Connect the power adapter to the camera, and wait for a few moments until the camera alerts you that the "Wired connection succeeded."

4. From your smartphone, search for "Foscam" via the App Store or Google Play Store. Download, install and open the app to begin configuration.
5. Under screen select "Tap to add a camera" and then select "Camera", after that scan the QR code, which is located at the bottom of your -camera (see illustrations below).

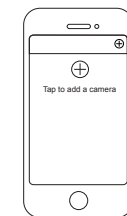

Tap + button



Scan the QR code which is located on your camera.

6. Wait a few moments for camera added successfully and set the camera name, then from the home screen, tap the play icon within the video feed box to bring up the camera credentials screen. For your security, please set a new username and password for your camera (see illustrations below).

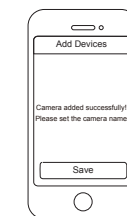

Camera added successfully!

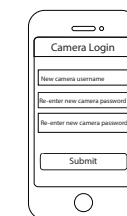

Camera Login

Note: If you want to add a deleted camera again on the Foscam app, you must first reset the camera, then reinstall according to the above Camera Setup Steps.

D. Connecting Your Camera Over WiFi

Once you've added your camera successfully using the wired connection method above, tap the play icon within the video feed box to bring up the camera credentials screen → tap the gear in the upper-right → tap "Network" → tap the WiFi network you wish to connect to and enter your WiFi password.

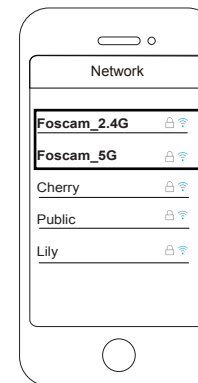

Note: The camera supports dual-band 2.4GHz and 5GHz WiFi network, you can choose a stronger channel to use.

E. Other Ways to Access Your Camera

■ Foscam VMS



Foscam VMS is a new tool for PC. It does not require plug-ins and is compatible with Windows & Mac, It supports all Foscam HD cameras and up to 36 cameras at the same time. If you would like to manage multiple cameras, we suggest you install the Foscam VMS. You can download the “Foscam VMS” from foscam.com/vms.

Add the IP Camera

1. Run Foscam VMS, then you can create a local administrator account and login.
2. Tap the "+" button on the Foscam VMS and follow the setup wizard to add your camera.

Please refer to the user manual for more detailed adding steps.

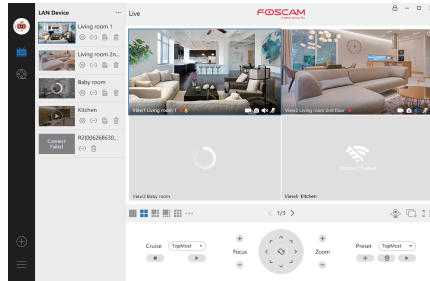

■ Web User Interface



(e.g.Internet Explorer/Edge/Chrome/Firefox/Safari)

If you would like to manage your camera more professionally, we suggest you access your camera via browser. You can download the “Equipment Search Tool” from foscam.com/tools to your computer, then access the camera directly.

■ Foscam Cloud Service



You can access the camera via the Foscam Cloud website:

<https://www.myfoscam.com>

Some of the benefits of viewing your camera in the cloud:

- It's simple and convenient to remotely access and manage all your WiFi security cameras.
- Enjoy the latest features first through Foscam Cloud including cloud storage and more.
- Getting started is fast—if you have already registered an account through Foscam App, you can directly use your login credentials for Foscam Cloud.

F. Hardware Installation

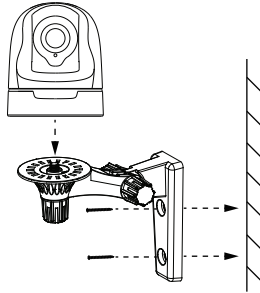

1. Screw the mount on the wall with the two screws provided.
2. Loosen the thumb screws to adjust the mount to the desired position. Once the position is set, tighten the screws securely.

G. Important Notice

■ Camera Username & Password

The camera username & password are used to access and manage your camera. Having a strong password can improve the security of your camera significantly.

If you have forgotten either of them, please press the "Reset" button and hold it for more than 15 seconds while the camera is powered on. After hearing the voice prompt, release the button. The camera will automatically reboot and the default settings will be restored.

You can reconnect the camera according to this Quick Setup Guide.

■ Foscam Cloud Service Account Username & Password

Your Foscam Cloud service account and password may be used to access both Foscam App and the Foscam Cloud service website. Therefore, you may register the account username & password on either one.

■ Storage Media

Your camera supports cloud, NVR (Network Video Recorder), and Micro SD card storage formats.

If you wish to record and playback large amounts of video, we recommend using a Foscam NVR device as well.

Foscam IP camera supports FAT-32 format only, if the SD card is not FAT-32 format, please format it to FAT-32 by Foscam camera before using. There are three ways of formatting:

- **Formatting SD card to FAT-32 on web/VMS:** Login the camera on

web/VMS, click **Settings** > **Record** > **SD Card Management** > **Format** to format the SD card to FAT-32 format.

- **Formatting SD card to FAT-32 on App:** Formatting SD card to FAT-32 on App, click **Settings** > **SD Card Video Playback** > **SD-Card Settings** > **format SD-Card** to format the SD card to FAT-32 format.

■ Firmware Upgrades

You can upgrade the firmware of your camera with Foscam App by using the new “one-key-Online Upgrade” feature (Open Foscam App and Login the camera, select “Settings” > “Firmware Upgrade”).

You also can download the latest version to upgrade your camera from our official website foscam.com/upgrades.

■ Safety Tips

- Please ensure that the proper power supply is used before using the camera.
- Please install the camera and bracket securely using the screws provided.
- To avoid the risk of fire or electric shock, please keep your camera in a cool, dry place.
- Please keep the camera out of reach of small children.
- Change your default port to a greater range to help ensure the safety of your connection.
- Check the logs of your Foscam cameras frequently. Foscam Cameras have embedded logs reminding you which IP addresses are accessing the camera.

H Product Performance

WLAN frequency range: 2412MHz - 2472MHz and
5725MHz - 5875MHz

Maximum transmission power: < 17dBm

Wireless Standard: IEEE802.11b/g/n (2.4GHz)

IEEE802.11a/n/ac (5GHz)

Power Supply: DC 5V 2.0A 10W

I Technical Support

If you have problems with your Foscam device, please contact the reseller you purchased from, or you can e-mail the headquarter technical support team: support@foscam.com

Your valuable comments and suggestions on improving Foscam products are welcomed!



CE Certificate statement Website:

<http://www.foscam.com/company/ce-certificate.html>

Exporter and Importer Information Opened to Public:

<http://www.foscam.com/company/open-information.html>

Manufacturer: Shenzhen Foscam Intelligent Technology Co., Ltd

Addr: 9/F, Block F5, TCL International E City, No.1001

ZhongShanyuan Rd., NanShan District, Shenzhen, China, 518055

www.foscam.com

As a result of product upgrades and other reasons, this guide may not be able to update in time, resulting in inconsistency with the official website information, please take the official website (www.foscam.com) information as the standard.